



BASE 45 M Full-Motion TV Wall Mount

Key Benefits

- Strong and Simple: solid, secure solutions to mount your TV
- Smoothly turn your TV up to 180°
- Tilt (up to 15°) to avoid reflections

For TVs up to 55 inch (140 cm)

BASE 45 M is a durable TV wall mount, suitable for 32 to 55 inch (81 to 140 cm) TVs weighing up to 30 kg (66 lbs). Extra wide angle of rotation for an excellent viewing experience! The BASE 45 M has an extra-wide turn angle of up to 90 degrees left or right. That means you can get the perfect viewing angle from anywhere in the room, and possibly even from adjacent rooms. You can fold it flat against the wall when you're not watching TV, for the best of both worlds.

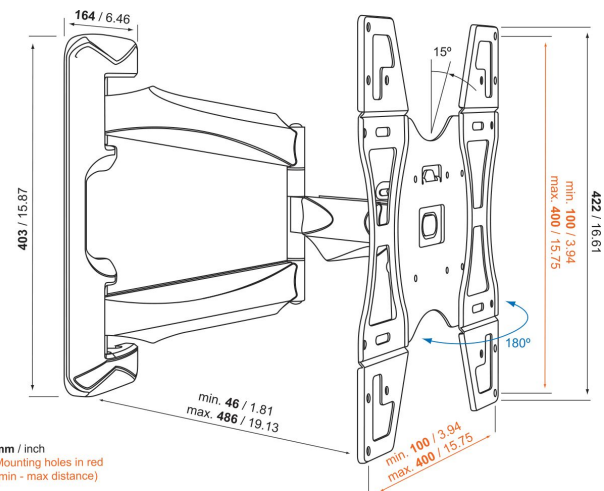



BASE 45 M Full-Motion TV Wall Mount

Specifications

Min. screen size (inch)	32
Max. screen size (inch)	55
Universal or fixed hole pattern	Fixed
Max. height of interface (mm)	422
Max. width of interface (mm)	427
Max. weight load (kg)	30
Max. weight load (Lbs)	66.14
Turn	Full motion (up to 180°)
Tilt	Tilt up to 15°
Cable management	Integrated cable management
Service position	No
Spirit level included	No
Article number (SKU)	8343245
EAN single box	8712285324284
Colour	Black
Certifications	TÜV
TÜV certified	Yes
Guarantee	Lifetime

VOGEL'S HOLDING BV (©)

All rights reserved.
Subject to printing errors,
technical and price
amendments.

Date: 2025-05-28



Vogel's. For Sure.