

## Loewe TV compatibility with Vogel's MotionMount

All Bild 1-9 Connect UHD, Art UHD, One UHD TVs (with 'Chassis SL4xx') with manufacturing date from 2016 onwards, can be updated with Loewe firmware version 5.0.27 (or higher). This firmware makes the Loewe Bild TV compatible with the Vogel's MotionMount. The MotionMount is linked with the Loewe TV via Bluetooth, making control of MotionMount possible with the Loewe TV remote control. Also Auto Home is controlled by the Loewe TV via Bluetooth.

### How to install the Vogel's MotionMount in combination with a Loewe TV

1. Install the MotionMount as mentioned in the Mounting Instructions.
2. Make sure your Loewe TV is updated to the latest firmware version (min. required version 5.0.27). Enable in TV menu Bluetooth and select MotionMount from the available Bluetooth devices. Go to: **Other settings > Multimedia/Network > Bluetooth > Select Bluetooth device: Vogel's MotionMount**. The Bluetooth link between TV and MotionMount is unique.
3. Make sure the firmware of the MotionMount is updated to the latest version. This can be checked in the MotionMount app. Go to: **Settings > Support** (min. required is firmware version 1.1.7). Hereafter, you can control the MotionMount with the Loewe TV remote control and menus on the tv screen.

In the MotionMount (app), the TV-on/off detection based on power consumption measurement should be automatically disabled (Auto Home is controlled by Bluetooth from TV set). In case TV-on/off detection is not being disabled automatically, switch it off manually in the MotionMount app (see picture below).

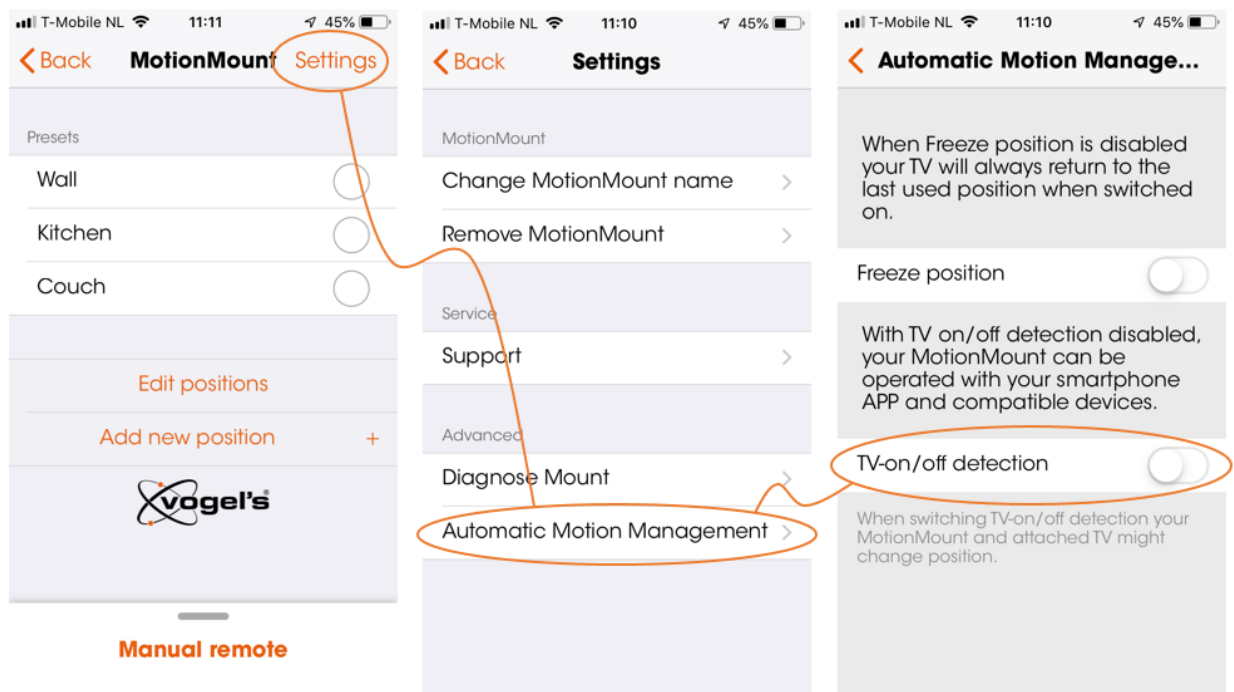

**Attention:** TV-on/off detection MUST always BE DISABLED (switched off)! Otherwise the MotionMount will not work properly.

How to use / control the Vogel's MotionMount with a Loewe TV remote control

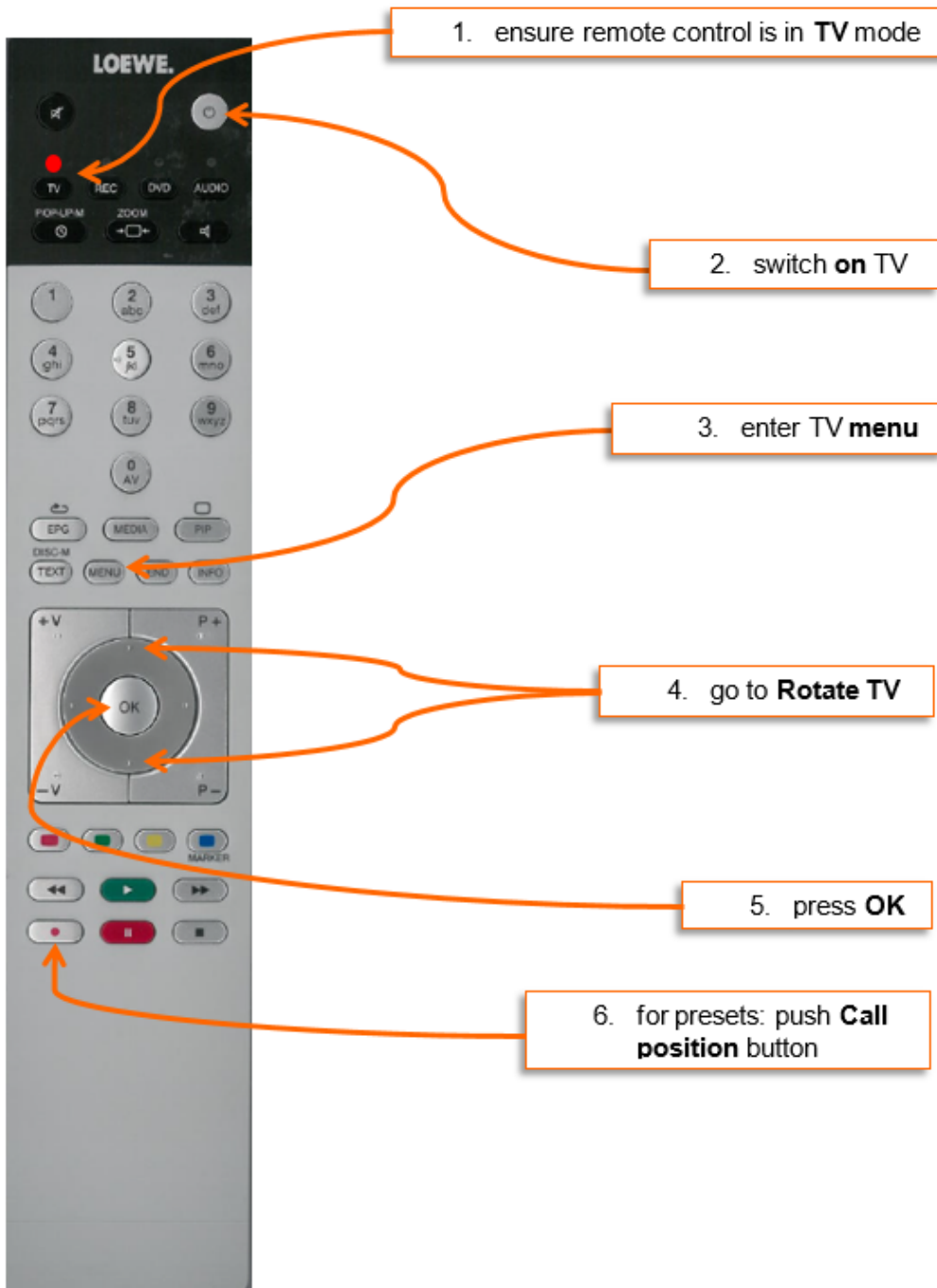

Attention: Always point the remote control to the front of the television (infra-red eye)!

---

For further information please contact: [salesconsumer@vogels.com](mailto:salesconsumer@vogels.com)